

# GUTMANN RV-KSI



BUILDING SYSTEMS

ALUMINIUM EXTERIOR WINDOW SILLS & SYSTEM ACCESSORIES

04.2017



## ECONOMICAL AND COST-EFFECTIVE

New window sill holder with high efficiency for GUTMANN aluminium window sills GS40 and GS25

## GUTMANN RV-KSI

### WINDOW SILL HOLDER FOR GS40 AND GS25

GUTMANN is expanding its accessories range for aluminium exterior window sills. With expertise and consistency, this further enhances the system concept. The new, innovative RV-KSI window sill holder from GUTMANN is made of high-quality polyamide plastic. This material significantly improves thermal insulation values in the facade.

The new accessory from GUTMANN ensures reliable stability as well as rapid fastening to the window sill thanks to an intelligent clip mechanism in the front area of the holder. It's an additional plus for fabrication. The GUTMANN RV-KSI window sill holder is suitable for use in GUTMANN GS 40 and GS 25 window sill systems.

### - ECONOMICAL AND COST-EFFECTIVE - NEW WINDOW SILL HOLDER WITH HIGH EFFICIENCY



Standard aluminium flat part from the accessories program

GUTMANN Holder RV- KSI



Clip connector for simple fastening



Main casting made of high-quality polyamide plastic



Infinitely adjustable thanks to tension springs

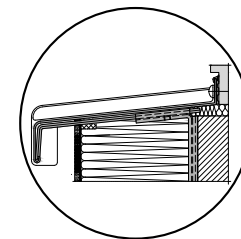

Aluminium window sill with holder RV-KSI

- ✓ For secure fastening of the window sill
- ✓ Ininitely adjustable thanks to tension springs
- ✓ According to installation guidelines, it is for use with projections of 150 mm and greater
- ✓ Cost-effective, rapid assembly
- ✓ Significantly improved thermal insulation values