



# GUTMANN GCW 050|060

## ALUMINIUM FACADE SYSTEM



GUTMANN –  
New dimensions  
offer new  
perspectives

GUTMANN-BAUSYSTEME.DE

ALUMINIUM SHAPED BY GUTMANN



## GUTMANN GCW 050/060 ALUMINIUM FACADE

Innovative technology at its peak, more design and constructive flexibility

The GUTMANN GCW 050 | 060 facade system provides space for both creative planning and solid design. The uniform system design supports cost-effective and efficient manufacture. The GUTMANN GCW 050 | 060 is suitable for vertical facades. Designing and cladding any kind of building is easy.

## SYSTEM DESCRIPTION

- › Filling thicknesses up to 65 mm | Filling weights up to max. 730 kg.
- › Identical insulator for mullion and transom.
- › Same profiles for mullion and transom, straight material cuts, no notching of the transom profile: minimal waste, efficient finishing and installation.
- › High cost-effectiveness due to identical internal glazing gasket and glazing with internal sealing frames (vulcanised).
- › Low edge radii for a clear appearance.
- › Design available in Structural Glazing (export version), semi-SG and visual-SG.
- › Also available as a passive house variant.
- › Transom connector for simple and secure transom connection.
- › Static values can be increased by inserting aluminium or reinforcing steel profiles.

## SYSTEM PROPERTIES OF CLASSES



Water tightness

**RE 1200**



Air permeability

**2,0 kN/m<sup>2</sup>**  
**3,0 kN/m<sup>2</sup>**



Wind load

**AE**



Mechanical strength

**E5/I5**

## THERMAL INSULATION

Ucw 3 triple<sup>1</sup>



<sup>1</sup> Element size: 2.660 x 2.665 mm | Ug value: 0,7 W/m<sup>2</sup>K | Up value: 0,25 W/m<sup>2</sup>K  
Glass spacer: Thermix TX.N plus

## SYSTEM CROSS SECTION

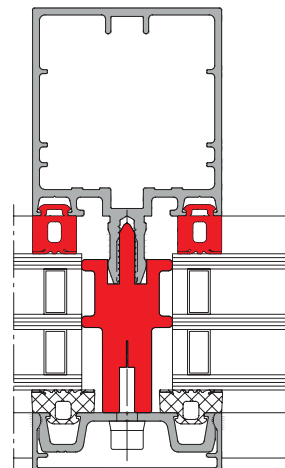
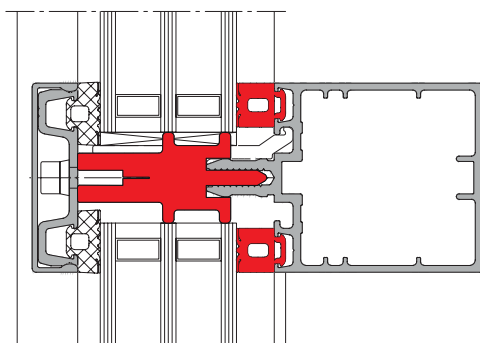



**GUTMANN –**  
Innovative  
technology  
at the  
highest level

**BECOME A GUTMANN PARTNER  
AND ENJOY THE FOLLOWING ADVANTAGES:**

- Many years of experience and expertise in the facade business.
- From your own tool correction to pressing, coating and joining - everything under one roof.
- We offer you everything from a single source: structural engineering advice in the design and planning phase of a building, support in the implementation of existing system technology with special system-based solutions.
- Top quality products are our trademark and the basis of our reputation.
- High storage capacity and efficient logistics ensure fast and punctual delivery.
- Maximum customer benefit characterized by a successful combination of sophisticated design, certified safety and sustainable profitability.



**GUTMANN BAUSYSTEME GMBH**

Nürnberger Straße 57 – 91781 Weißenburg, Germany  
T 09141-995 11 36 – E [info@gutmann.de](mailto:info@gutmann.de)

**GUTMANN-BAUSYSTEME.DE**